

CITY OF POMPANO NOTES

1. IF THE TREES ARE TO BE CANTERLIZED THE ROOT BALL SHALL BE SHAVED AT THE PERIPHERY TO REMOVE ALL CIRCLING ROOTS.
2. PLANT SPACING SHALL SUPERSEDE PLANT QUANTITY TO FILL THE BED
3. AS PER 155.5204.F. NO DEVELOPMENT, WORK, OR DEMO ACTIVITY SHALL BE ALLOWED WITHIN THE DRILLPIE OF A TREE OR TREE PROTECTION AREA.
4. FINES AND PENALTIES FOR ENCROACHMENT INTO THE CRITICAL ROOT ZONES AND WITHIN THE TREE PROTECTION ZONE FOR EXISTING TREES TO BE PROTECTED AND PRESERVED.
5. ALL EXISTING TREES SHALL BE PRUNED BY AN ISA CERTIFIED ARBORIST UNDER THE DIRECTION OF A BOMA OR ASCA REGISTERED CONSULTING ARBORIST.
6. AS PER 155.5204.F.3.d: UNDERGROUND UTILITY LINES SHALL BE ROUTED AROUND THE TREE PROTECTION AREA, WHERE POSSIBLE. IF THIS IS NOT POSSIBLE, A TUNNEL MADE BY A POWER-DRIVEN SOIL AUGER MAY BE USED UNDER THE TREE.
7. ALL TREES DESIGNATED AS SINGLE TRUNK SHALL HAVE A SINGLE, RELATIVELY STRAIGHT, DOMINANT LEADER, PROPER STRUCTURAL BRANCHING AND EVEN BRANCH DISTRIBUTION. TREES WITH MULTIPLE TRUNKS, TIPPED BRANCHES, AND CO-DOMINANT TRUNKS WILL NOT BE ACCEPTED. TREES WITH GIRDLING, INTACT LEADER CIRCLING AND/OR PLUNGING ROOTS WILL BE REJECTED.
8. ALL HEDGES ABUTTING CITY RIGHTS OF WAY ARE MAINTAINED AT A HEIGHT NO GREATER THAN 24". IT IS STAFFS RECOMMENDATION THAT ALL TREES VIA PERIMETER TREES BE 14' OA TO CREATE A LARGER-CUTTED CLEAR LINE OF SITE FROM ROADWAY.
9. PRE-CONSTRUCTION MEETING WITH URBAN FORESTRY IS REQUIRED BEFORE ANY PLANT MATERIAL IS INSTALLED ON SITE.
10. ALL ROAD ROCK, CONCRETE, ASPHALT AND OTHER NON NATURAL MATERIAL BE REMOVED FROM ALL PLANTING AREAS PRIOR TO LANDSCAPE INSTALLATION AND BE REPLACED WITH PLANTING SOIL PRIOR TO LANDSCAPE INSTALLATION.
11. ALL TREE WORK WILL REQUIRE PERMISSION BY A REGISTERED BROWARD COUNTY TREE TRIMMER.
12. LANDSCAPE MATERIALS OTHER THAN SOD ARE NOT ALLOWED WITHIN 5' OF ANY PORTION OF CITY OWNED UTILITIES.
13. ALL LANDSCAPE MATERIAL WILL BE FLORIDA #1 GRADE OR BETTER.

PLANT LIST

KEY	QTY	PLANT AND SPECIFICATION
TREES		
** AM2	2	Adonia merrillii (Double Adonia Palm) 12' ht., double, heavy, matched
** N CES	4	Conocarpus erectus 'Sericeus' (Silver Buttonwood) 12' ht., 5' spr., standard, 5' c.t., 2" cal., matched
** N CE	3	Conocarpus erectus (Green Buttonwood) 16' ht., 6' spr., standard, 7' c.t., min. 3" cal., matched
** N CD	8	Coccoloba diversifolia (Pigeon Plum) 16' ht., 6' spr., standard, 6' c.t., min. 3" cal., matched
** CN	4	Cocos nucifera (Coconut Palm) 12'-14' g.w., heavy, matched
** ED	6	Elaeocarpus decipiens (Japanese Blueberry) 12' ht., 4' spr., standard, 3' c.t., 2" cal., matched
PE	8	Ptychosperma elegans (Alexander Palm) 22' o.a. ht., single, matched
PE2	14	Ptychosperma elegans (Triple Alexander Palm) 22' o.a. ht., double, matched
PE3	5	Ptychosperma elegans (Triple Alexander Palm) 22'-14' o.a. ht., triple, matched
VM	3	Veitchia montgomeryana (Double Montgomery Palm) 16' o.a. ht., heavy, matched

KEY	QTY	PLANT AND SPECIFICATION
<u>SHRUBS, GROUNDCOVERS & ACCENTS</u>		

N	CHR		
** N	CHR	50	<i>Chrysobalanus icaco</i> 'Horizontal' (Horizontal Cocoplum) 16' ht., 16" spr., 24" o.c., full
**	CRI	3	<i>Crinum</i> sp. (White Crinum Lily) 36" o.r. full, 3 p.p.p., full
	DIO	3	<i>Dioon edule</i> 4' o.a., symmetrical, matched
**	FGI	89	<i>Ficus microcarpa</i> 'Green Island' 14" ht., 14" spr., 18" o.c., full
	FIC	35	<i>Ficus pumila</i> (Creeping Fig) 12" o.a., 12" runners, 12" o.c., full
**	LAN	40	<i>Lantana</i> (Yellow Trailing Lantana) 14" o.a., 16" o.c., full
	MIC	36	<i>Microsorium scolopendria</i> (Wart Fern) 14" ht., 14" spr., 18" o.c., full
	PBM	202	<i>Philodendron</i> 'Burle Marx' 14" ht., 14" spr., 18" o.c., full
	PHI	3	<i>Philodendron giganteum</i> 30" ht., 30" spr., full, matched
** N	PSY	152	<i>Psychotria nervosa</i> (Wild Coffee Hedge) 3' ht., 24" spr., 24" o.c., full
**	PEN	50	<i>Pennisetum setaceum</i> (White Fountain Grass) 30" ht., 20" spr., 24" o.c., full
	POD	149	<i>Podocarpus macrophyllis</i> (Podocarpus Hedge) 5' ht., 24" spr., 24" o.c., full
	PRI	89	<i>Podocarpus macrophyllis</i> 'Pringles' 14" ht., 14" spr., 18" o.c., full
**	PR3	3	<i>Phoenix roebelenii</i> (Triple Pygmy Date Palm) 5' o.c., triple, matched, heavy, full
** N	TR	2	<i>Thrinax radiata</i> (Thatch Palm) 4' ht., 3' spr., heavy, matched
	SOD		St. Augustine 'Palmetto' Contractor to determine quantity.
	MULCH		3" depth, dark brown, non-Cypress mulch Contractor to determine quantity.
	SLATE CHIPS		3" depth, medium size Contractor to determine quantity.
N	DENOTES NATIVE SPECIES		
**	FLORIDA-FRIENDLY SPECIES		

INTRACOASTAL WATERWAY

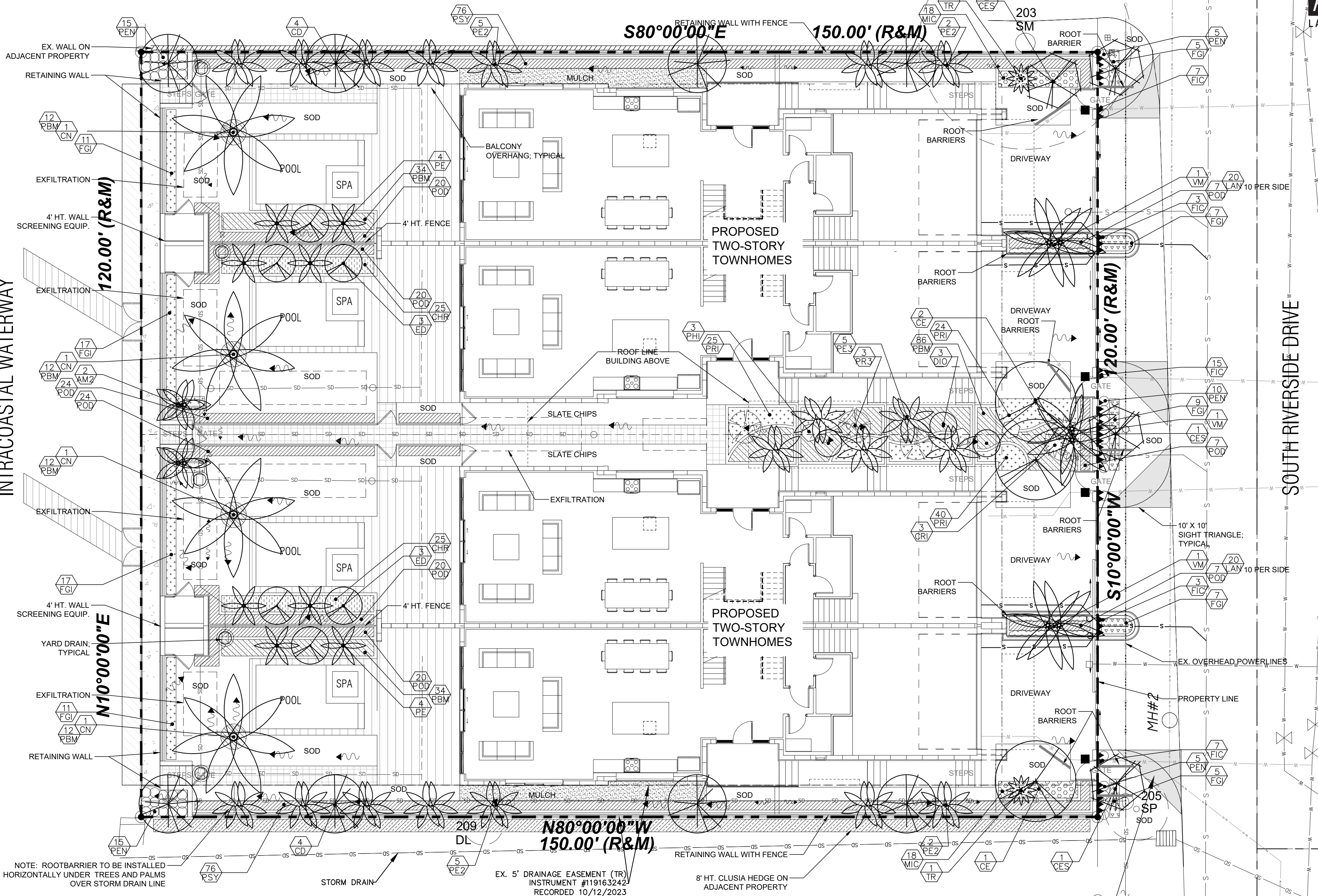

TREE MITIGATION DATA

TREE REPLACEMENT: ADD 1 CALIPER INCH PER 1 DBH INCH REMOVED IN ADDITION TO REQUIRED TREES
TOTAL DBH INCHES REMOVED: 160 INCHES
TOTAL CALIPER INCHES PROPOSED: 0 INCHES
MITIGATION REPLACEMENT WILL BE PAID TO THE CITY OF POMPANO BEACH TREE FUND

PALM REPLACEMENT: 1 FOR 1
TOTAL PALMS REMOVED: 7 PALMS
TOTAL PALMS PROPOSED: 7 PALMS

ITEM	REMOVED	REPLACED
\$ SPECIMEN VALUE	\$0	\$14,350 TREES REPLACED
PALM HEIGHT	108'	664'
DBH (NON-SPECIMEN)	160"	53" CALIPER

SEE PLAN FOR LOCATION AND
LINEAR FOOTAGE

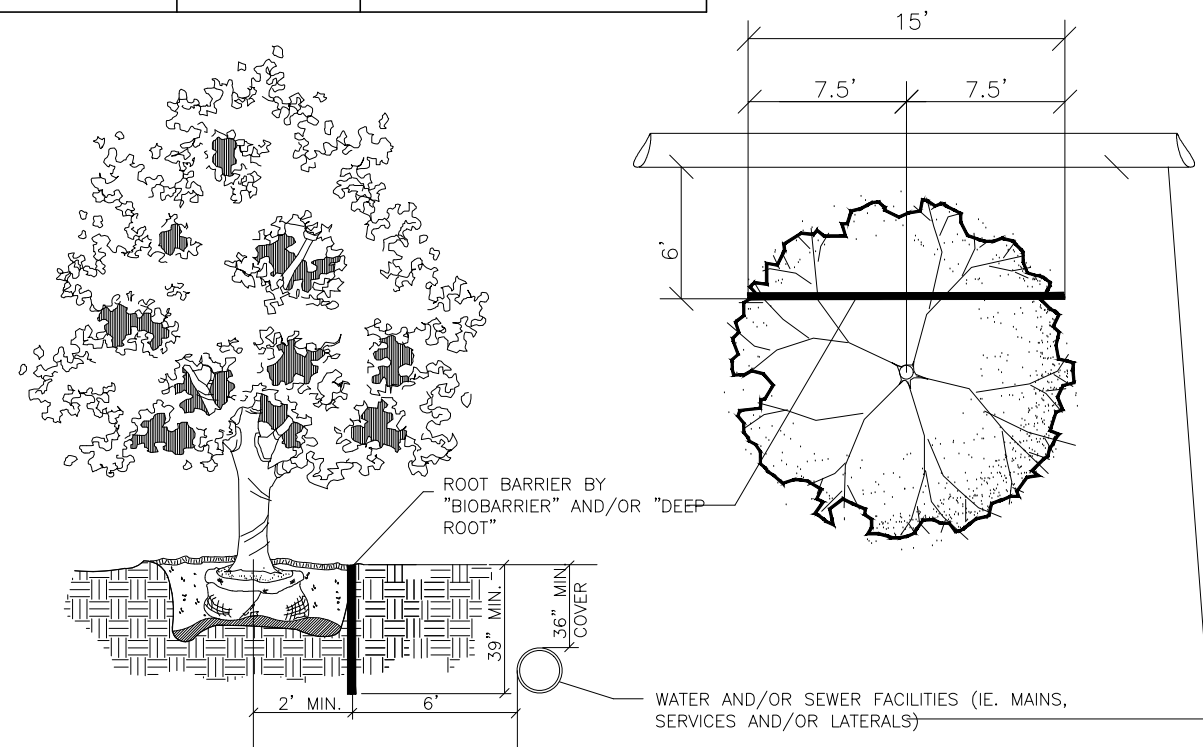

ROOT BARRIER DETAIL

ROOTBALL LOCATIONS TO BE 6' AWAY FROM WATER/SEWER/UNDERGROUND UTILITY LINES AND HARDSCAPE WITH USE OF ROOT BARRIER, AND 10' AWAY WITHOUT ROOT BARRIER.

SITE CALCULATIONS

ITEMS	REQUIRED	PROPOSED
A. TOTAL LOT AREA		18,000 S.F.
B. STRUCTURE, WALKWAYS, DRIVESWAYS, ETC	13,500 S.F.	13,458 S.F.
C. PERVIOUS LOT AREA	4,500 S.F. (25%)	4,542 S.F. (25.23%)

EXISTING TREE SYMBOLS



EXISTING TREE KEY

KEY	NAME
DL	Areca Palm
SM	Mahogany
SP	Sabal Palm

LANDSCAPE CALCULATIONS

ITEMS	REQUIREMENT	LENGTH (L.F.)	REQUIRED	PROPOSED
NORTH BUFFER	1 TREE/ 40 L.F.	150	4 TREES	4 TREES (4 PIGEON PLUMS)
EAST BUFFER	1 TREE/ 30 L.F.	120	4 TREES	4 TREES (4 GUMBO LIMBOS)
SOUTH BUFFER	1 TREE/ 40 L.F.	150	4 TREES	4 TREES (4 PIGEON PLUMS)
WEST BUFFER	1 TREE/ 30 L.F.	120	4 TREES	4 TREES (4 COCONUT PALMS)
STREET TREES	1 TREE/ 40 L.F.	120	3 TREES	3 TREES (3 GUMBO LIMBOS)
MIN. DEVELOPMENT SITE LANDSCAPE	1 TREE/ 3,000 S.F.	(18,000 S.F.)	6 TREES	6 TREES (6 JAPANESE BLUEBERRIES)
	TOTAL TREES		25 TREES	25 TREES
PALM TREES	MIN. 20% OF TOTAL		4 PALMS MAX.	4 PALMS
NATIVE TREES	MIN. 50% OF TOTAL		13 TREES	13 TREES
SPECIES	MIN. 4 SPECIES		4 SPECIES	4 SPECIES
INTERIOR SHRUBS	5 SHRUBS/ 3,000 S.F.(18,000 S.F.)		30 SHRUBS	>30 SHRUBS